

HYBRID STEPPING MOTOR

MOD. 110BYG350C

Wiring Diagram:

Dimensions:
(unit=mm)

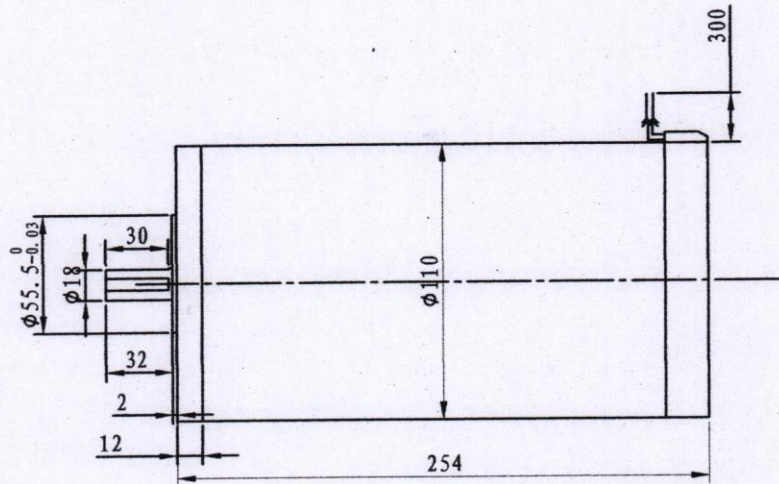
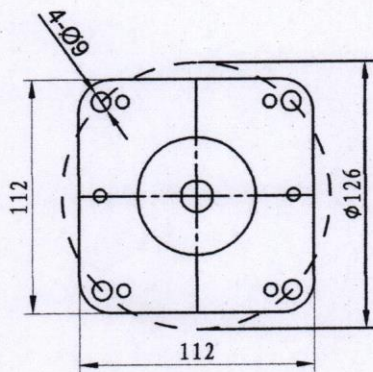
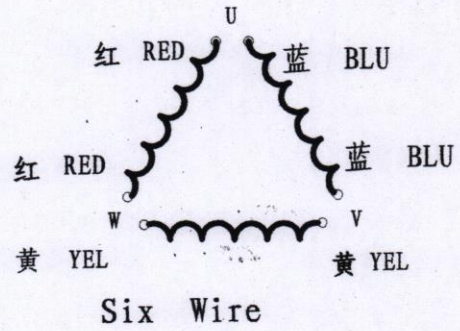

Wire Type

Electrial specifications

STEP ANGLE (步距角)	0.6/1.2 ° /STEP	COMMENT
RATED VOLTAGE (电压)	80-350 V	
CURRENT (电流)	4 A/PHASE	
RESISTANCE (相电阻)	2.83 Ω/PHASE	
INDUCTANCE (相电感)	23 mH/PHASE	
HOLDING TORQUE (保持转距)	25 N.m	
INSULATTON CLASS	B	
NUMBER		

110BYG350C

江苏惠斯通机电科技有限公司

设计

陈超

日期

2014.3.3

审核

[Signature]

日期

2014.3.3